

## INSTALLATION INSTRUCTIONS

Ford Explorer Interceptor 2011+  
Side Brackets

TruckVault Inc  
(800) 967-8107  
www.truckvault.com

# TRUCKVAULT

### Tools Required:

Short Phillips screwdriver  
15mm Socket  
7/16 socket/wrench

### Materials Included:

1 - Explorer passenger mounting bracket 201.007.03  
1 - Explorer driver mounting bracket 201.006.02  
4 - 1/4" x 1" Hex bolts  
4 - 1/4" Fender washers  
4 - 1/4" Lock washers

**Personnel Required: Two (2) people**

**Congratulations! You now own the finest secure vehicle storage system on today's market. Enjoy the confidence you'll experience when traveling with your valuables safely locked in your TruckVault.**

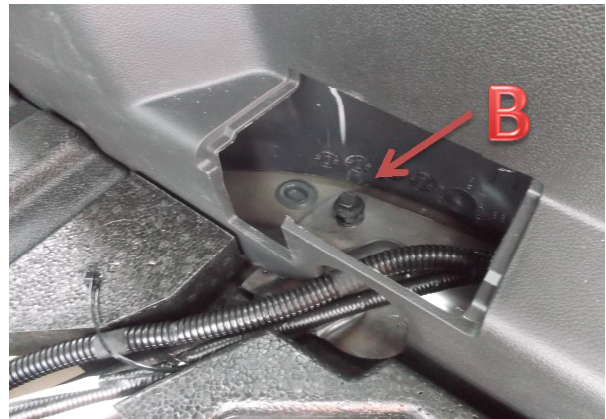

### DRIVER SIDE

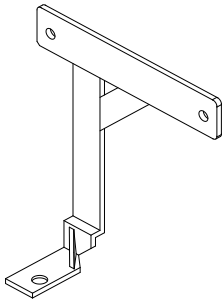

### PASSENGER SIDE

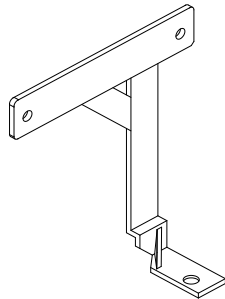

- 1 Open the TruckVault drawers just far enough to reach in and unscrew the rubber stoppers from the underside of the truckvault. Now completely remove the drawers and set aside. To remove drawers with slides, pull out far enough to expose the black glide locks on each side. Lift up on the glide locks and pull the drawer completely out.
- 2 Locate the plastic covers on the left/right sides of cargo area behind the wheel wells and remove them by pressing down on the top to release tabs (A). Remove existing bolts with 15mm socket (B). Install left & right metal brackets (notched part of bracket goes towards rear of vehicle) using factory bolt. Be sure bracket is parallel with plastic trim (C). Tighten bolts and replace plastic cover over brackets.
- 3 Carefully slide Truckvault into the cargo area of your vehicle. Align T-nut holes on the truckvault with the holes on installed brackets (D). Use a small screwdriver through the T-nuts to help align Truckvault holes with bracket holes. Feed supplied 1" bolts, lock washers & fender washers through the bracket and into the Truckvault leaving them slightly loose until all bolts are attached to the Truckvault. Tighten all bolts.
- 4 Reinstall the drawer & rubber stops by reversing the procedure in step 1.

